



2+



2



0,3m



1 = 1,6m 2 = 0,4m 3 = 0,3m

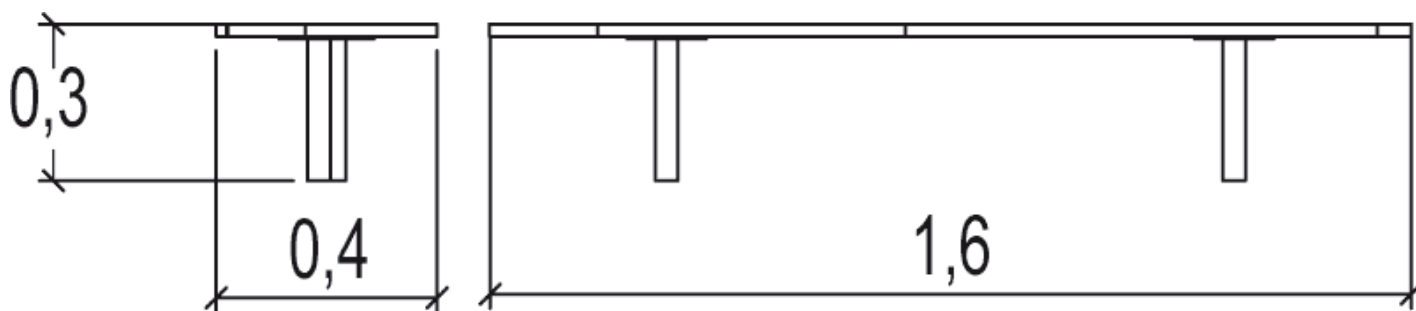



## Play value

balancing



## Accessibility

-  Motor disability
-  Sensorial Disabilities
-  Learning Disabilities

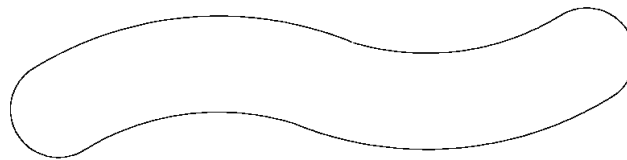



## Installation of equipment

Impact area =

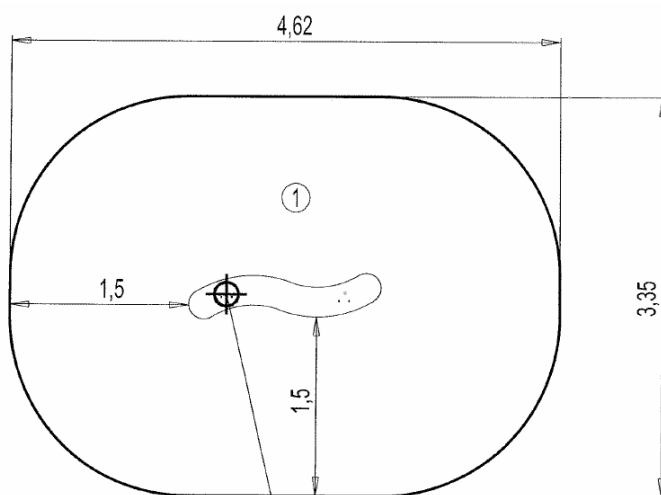
-  Impact area
-  Free space



0 Point de Référence  
Setting Out Point  
Punto de referencia  
Bezugspunkt

		
1	0,30m	14m <sup>2</sup>



1



00h45



0.06m<sup>3</sup>



14m<sup>2</sup>



10kg



5kg

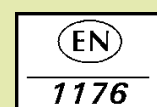

*Proludic*

2007-01-01