



1=1.59m 2=0.52m 3=0.6m



Please enter your username

 and your password.

If you don't have a password,

 click here

INSTALLATION

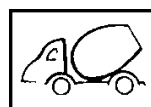

0.1m3



1

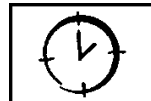

01h00

Galvanised steel tubes. Racks: diameter 14mm - Supporting bars:
42mm diameter - Side posts: 90mm diameter

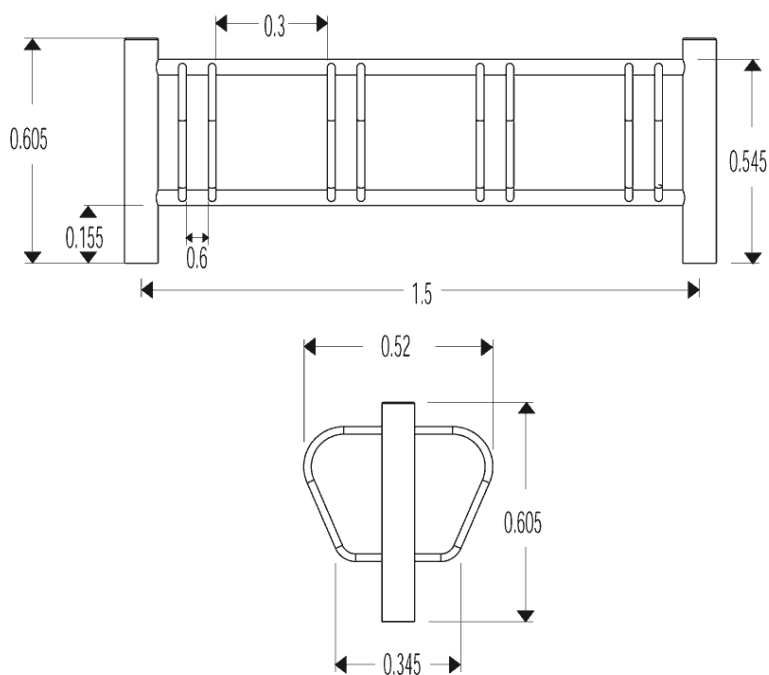

Total weight = 51 kg

Heaviest part = 51 kg