

5 55 240 5

## Basis Double spring rocker Grasshopper







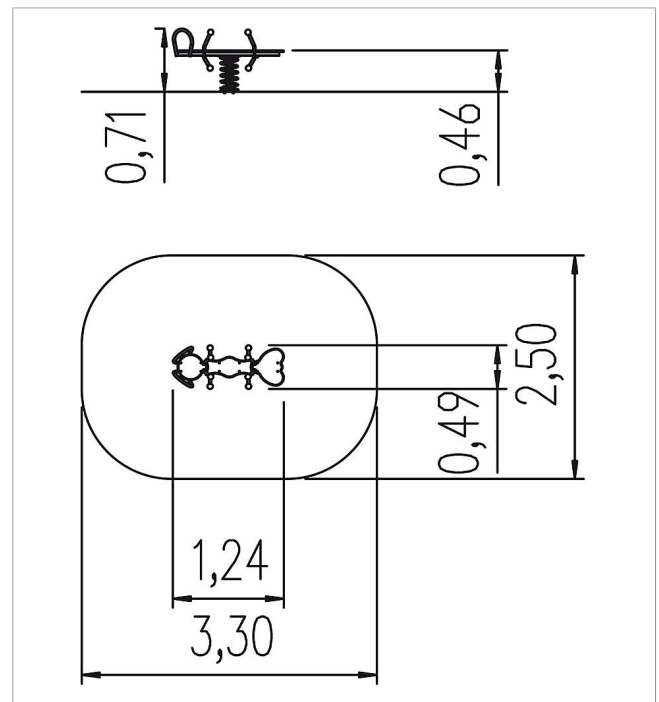

made in germany

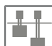

### Scope of delivery

- 1x base construction: powder-coated steel
- 2x seat surface: PE
- 1x covering: PE
- 1x spring: spring steel



	Material	Steel, PE
	Foundation level	FL 0
	Minimum space	3,30x2,50x2,26 m
	Free falling height	46 cm
	Impact protection net	7,5 m <sup>2</sup>
	Foundations	1x 5632280 + 1x CF
	Assembly	1 person/0.5 h
	Largest section	124x45x44 cm
	Heaviest section	16 kg