

5 59 809 0

Basis Little Beetle spring rocker







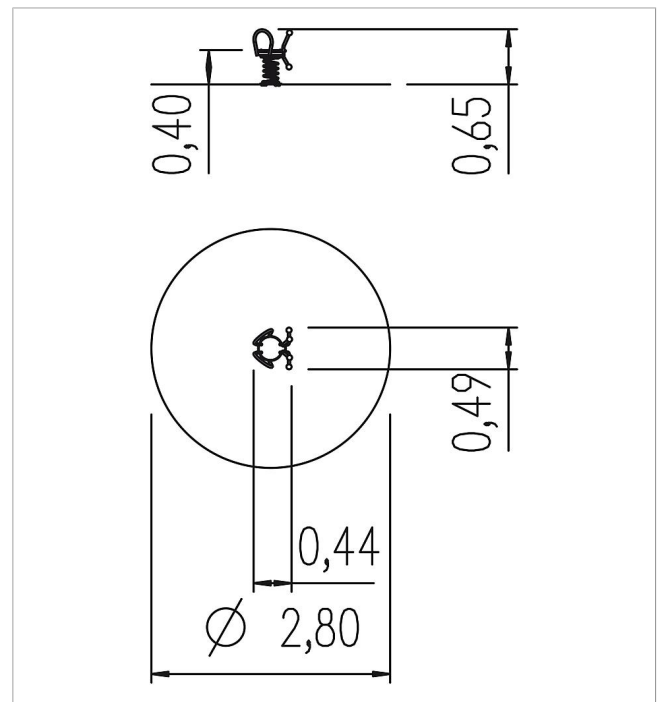

made in germany

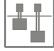

Scope of delivery

- 1x spring see-saw-body: powder-coated steel
- 1x seat: PE
- 1x spring: spring steel

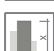

	Material	Steel, PE
	Foundation level	ET 0
	Minimum space	Ø 2,80x2,40 m
	Free falling height	40 cm
	Impact protection net	6,5 m ²
	Foundations	1x 5591600 + 1x CF or 1x 5632100 + 1x CF
	Assembly	1 person/1 h
	Largest section	45x45x45 cm
	Heaviest section	20 kg