



1+



10



0,6m



1 = 1,36m
2 = 1,3m
3 = 1,48m

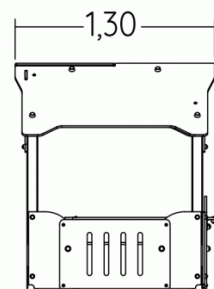
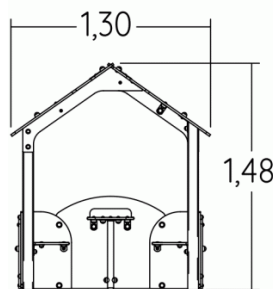

Play value :

4

role play



x1

meeting



x1

resting



x1



hiding





x1

Installation of equipment

IMPORTANT: It is essential to refer to the installation instructions for information on the size of the safety areas.

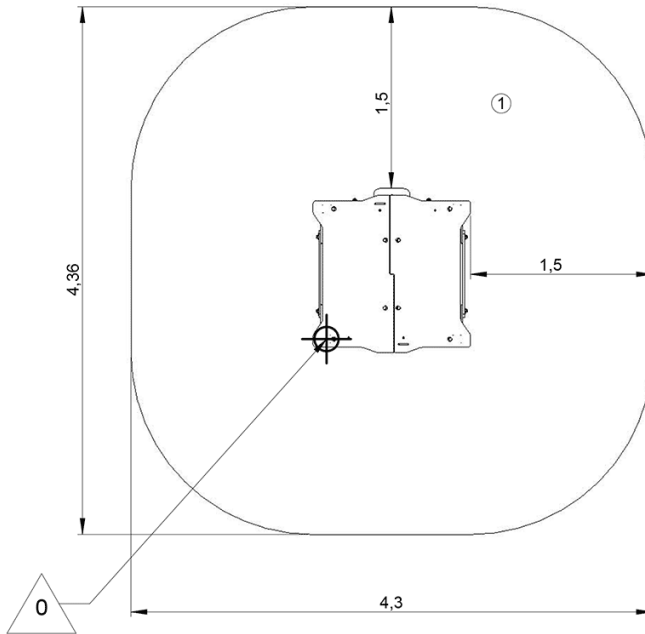
-  Impact area (minimum normative surface)
-  Free space



| | | |
|---|---|---|
| |  |  |
| 1 | <0,6m | 17m ² |



2



02h00



0.14m³



17m²



129kg



15kg

